

School District of Amery FACILITIES REFERENDUM

OUR KIDS OUR COMMUNITY OUR FUTURE

VOTE²⁰₂₂
APRIL
5

Our goal is to always do what is best for Amery students and the community. Students spend seven hours a day in school, and though the Amery school campus is beautiful and functional, we have reached a point where we must address significant maintenance needs so that we can provide the educational environment that Amery students deserve. The referendum is focused on the following:

- Increasing school safety and security
- Improving building efficiency and sustainability
- Improving learning environments for student success
- Addressing structural repairs and failing building systems

This plan was developed using feedback gathered from the community survey, from the community listening sessions, and from professional evaluations of the condition and quality of our learning environments. The recommended plan includes projects at all four of the school buildings, but the most pressing needs are at the high school, which was built in 1976, and the elementary school, which was built in 1967.

WHY NOW?

Amery students have 'Exceeded Expectations' every year that Wisconsin has used the Accountability Report Card. Amery students have also excelled in ways that could never be measured by a state-mandated report card. **The future of our students is at stake – we want to continue providing the education our kids deserve.**

Amery families currently have the unique opportunity to select learning environments that are best for their children: Montessori, Project Based Learning, Traditional, Career & Technical Education Academies, College & Career Readiness Programs, and Early Childhood Programs. **The future of our programs is at stake - we want to continue providing these excellent experiences for our students.**

The district is nearly debt-free. It is time to invest in our future.

Interest rates remain near historic lows.

The maintenance, safety, and security needs of the district are not going away.

Amery Community Survey Results



68% of respondents

Would support the district pursuing a referendum to fund the maintenance issues described in the survey.

Compared to similar school districts, survey respondents scored Amery well above average in the following areas:

- 99th percentile
The School District of Amery is delivering a high-quality education.

- 81st percentile
The School District of Amery is building pride in the community.

- 70th percentile
The School District of Amery is managing funds appropriately.

LEARN MORE

Call 715-268-9771 ext. 272

Email REFERENDUM@AMERYSD.K12.WI.US

Visit the district website for detailed information and answers to frequently asked questions WWW.AMERYSD.K12.WI.US

Attend Community Meetings Feb 23 & March 7, 6:30 at the high school Watch your mailbox for district-wide mailings

Follow us on social media



School District of Amery



ameryschools



@AmerySchools

QUESTION 1 DISTRICT-WIDE BUILDING SYSTEM/INFRASTRUCTURE REPAIRS & IMPROVEMENTS

HIGH SCHOOL

\$35 Million

Building and Site Maintenance

- Repair the exterior masonry
- Replace the roof
- Replace the ceilings
- Replace the exterior doors
- Address classroom wall issues
- Improve and replace the mechanical systems (HVAC, plumbing, electrical)
- Repair and replace the parking lots and sidewalks

Building Code Impacts

- Install fire detection/suppression systems
- Renovate to meet accessibility requirements
- Replace the emergency generator and transfer switches

Building Finishes and Equipment

- Replace or refinish the flooring
- Install durable finishes over gypsum board in corridors
- Paint throughout the building

Proposed Learning Environment Improvements at the High School

1. Science Labs and Greenhouse

The science department has not been renovated or updated in over 20 years.

2. Locker Rooms

Renovations will include ventilation, plumbing, fixtures, flooring, painting, etc.

3. Woods and Metals Shops

Replace the ventilation and electrical systems to meet code and renovate the spaces for improved functionality.

4. Agriculture Lab and Greenhouse

Replace mechanical systems to meet code and renovate the spaces for improved functionality.

5. Cafeteria/Locker Commons

Update finishes and function as budget will allow.

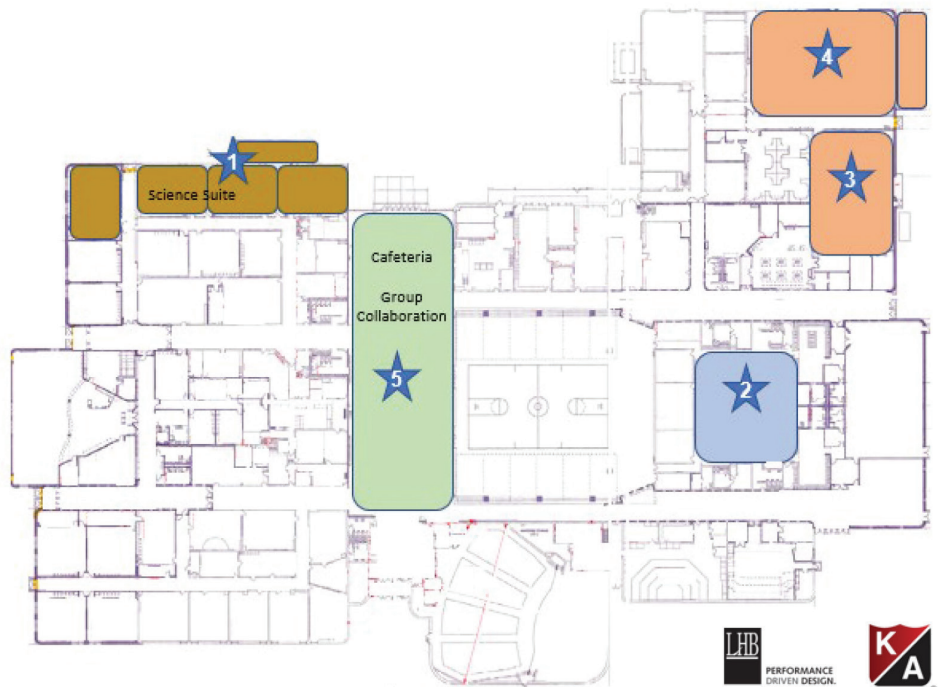

MIDDLE SCHOOL

Building and Site Maintenance

- Repair the exterior masonry
- Replace the heat pumps and cooling tower
- Replace the light fixtures with energy saving LED fixtures

Building Code Impacts

- Renovate to meet accessibility requirements

Building Finishes and Equipment

- Replace the lockers
- Refinish the gym floor

INTERMEDIATE SCHOOL

Building and Site Maintenance

- Repair the exterior masonry
- Repair the synthetic stucco finishes
- Repair the roof
- Upgrade the building automation system
- Replace the light fixtures with energy saving LED fixtures
- Repair and improve the parking lots and drive surfaces

Building Finishes and Equipment

- Refinish the gym floor

ELEMENTARY SCHOOL

Building and Site Maintenance

- Repair the exterior masonry
- Replace the 1967 roof section
- Add hot water piping to the classrooms

Building Code Impacts

- Renovate to meet accessibility requirements

Building Finishes and Equipment

- Replace the remainder of the flooring
- Replace the classroom casework

QUESTION 2 ELEMENTARY SAFETY & SECURITY UPGRADES WITH ADDITIONAL EARLY CHILDHOOD

ELEMENTARY SCHOOL & EARLY LEARNING CENTER

\$8.5 Million

Critical Challenges at the Elementary School:

- The electrical and building exhaust systems are out of date and no longer meet the building needs.
- Safety and security improvements are essential for the main entry, playground, and the traffic patterns.
- All program areas are short of space for classrooms and/or support spaces for required student services.
- The district and community are experiencing growing demand for early childhood services/childcare. Families unable to receive these services in Amery may enroll their children in other school districts or move to other school districts. The early childhood programs need more space and separation from the PK-2 programs for improved safety and to manage the constant coming and going of children and families.

Proposed Improvements at the Elementary School

1. Add a Parking Lot, Relocate the Main Entry, and Relocate the Playground
2. Upgrade the Mechanical/Electrical Rooms and the Receiving Area
3. Relocate the Early Learning Center for Additional Space and Security
4. Relocate the Art/Music and Administration Areas
5. Renovate Classrooms
6. Add Classrooms



School District of Amery Tax Rates

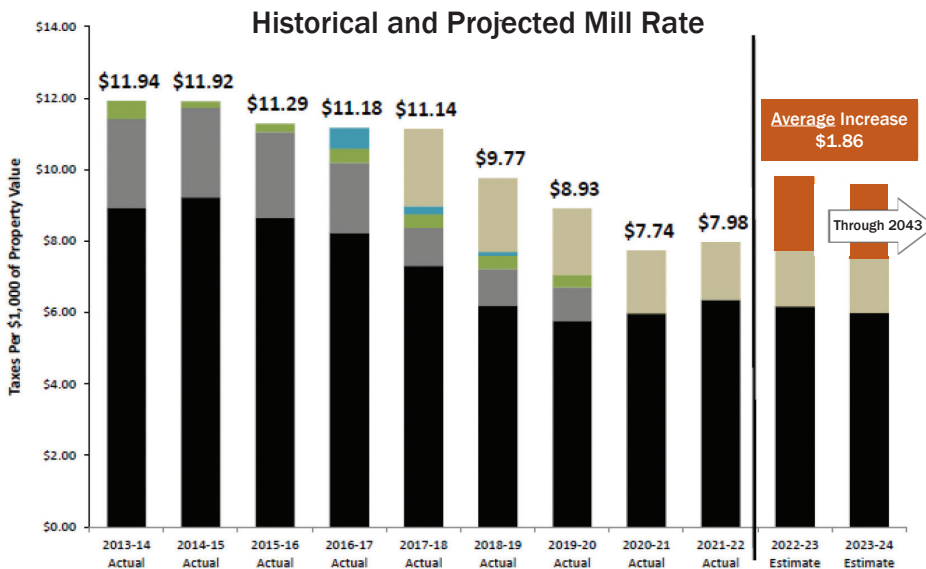

The district and Board of Education have worked very hard to be fiscally responsible; therefore, the district is nearly debt-free.

The total School District of Amery levy, which determines the school portion of local property taxes (mill rate), has dropped each year from 2014 until 2021.

The estimated increase of \$1.86 from the proposed referendum would still be lower than it was in 2018 and in previous years.

- Operating
- Referendum Debt Payments
- Energy Projects
- Debt Prepayment
- Operating Referendum
- April 22 Referendum*

*Includes effect of state aid (2021-22 October Aid Certification of -3.19%)

School District of Amery

543 Minneapolis Ave S
Amery, WI 54001

POSTAL PATRON

VOTE²⁰₂₂
APRIL
5

School District of Amery

**FACILITIES
REFERENDUM**

OUR KIDS OUR COMMUNITY OUR FUTURE

**BALLOT QUESTION 1 \$35 Million
District-wide Building System/
Infrastructure Repairs &
Improvements**

“For the purpose of paying the costs of improvements to the elementary, intermediate, middle and high school buildings and grounds including upgrades and renovations to major building systems; upgrades to safety and security systems; American with Disabilities Act (ADA) compliance renovations; upgrades and improvements to the intermediate and high school sidewalks, drives, and parking lots; upgrades and improvements to building exterior walls, roofing, flooring, lighting, doors and windows; upgrades and remodeling of high school classrooms and labs; and equipment acquisition related to said projects.”

**BALLOT QUESTION 2 \$8.5 Million
Elementary Safety & Security
Upgrades with Additional
Early Childhood**

“For the purpose of paying the costs of elementary school renovations and building additions; safety and security upgrades, upgrading and remodeling elementary classrooms; upgrades and improvements to sidewalks, drives, and parking lots; upgrading and renovating classrooms for the Early Learning Center; and equipment acquisition related to said project.”

Estimated Referendum Tax Impact

	Question 1	Question 2
Borrowing Amount	\$35,000,000	\$8,500,000
Average Mill Rate Impact per \$1,000 valuation	\$1.50	\$0.36

Tax Impact on Property

Property with Fair Market Value of \$100,000

Average Annual Impact	\$150.00	\$36.00
Average Monthly Impact	\$12.50	\$3.00

Property with Fair Market Value of \$200,000

Average Annual Impact	\$300.00	\$72.00
Average Monthly Impact	\$25.00	\$6.00



COMMUNITY MEETINGS

Amery High School

Join us to ask questions, to see some of the issues at the high school, and to learn more.

February 23 March 7
6:30 PM

